

# Loafer Shelter

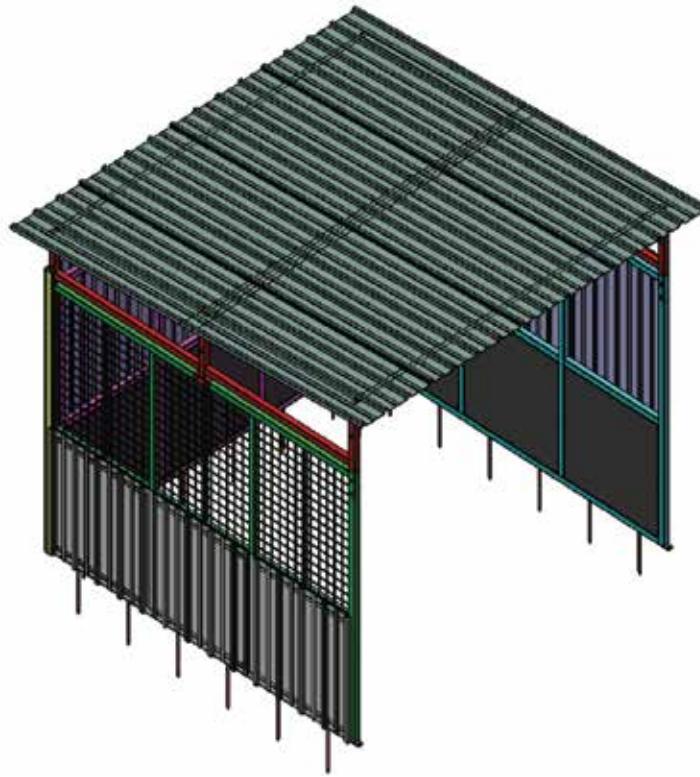

### Tools Recommended To Use



**Long Ladder**



**Long Socket for Drill**  
(19mm or 3/4 inch to fit Rattle Gun)



**Forklift or  
Two people**



**Socket for Roof Sheet Screws**  
(8mm or 5/16 inch)



**Rubber Hammer**



**Battery Rattle Gun/  
Impact Wrench Drill**



**Hole Poker would help to line  
up the holes for the bolts**



**Ring Wrench/Spanner**  
(19mm or 3/4 inch)

**1 x Left-Side Frame**

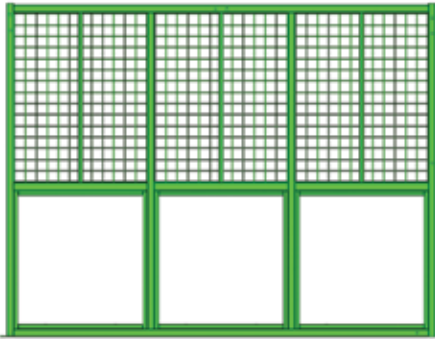

**1 x Back Frame**

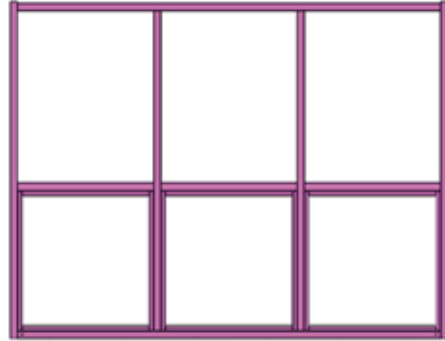

**1 x Right-Side Frame**

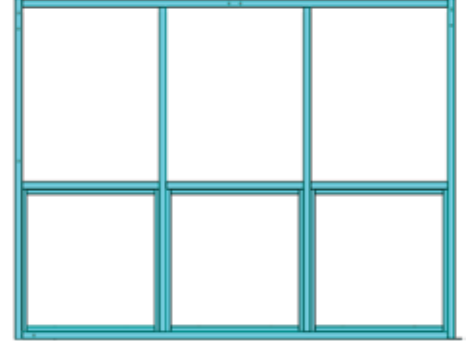

**2 x Left & Right Roof Lifters**

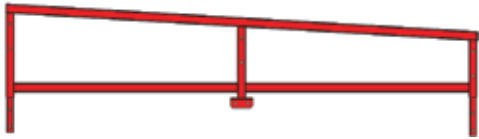

**3 x Roof Trusses**



**8 x Sheeting**

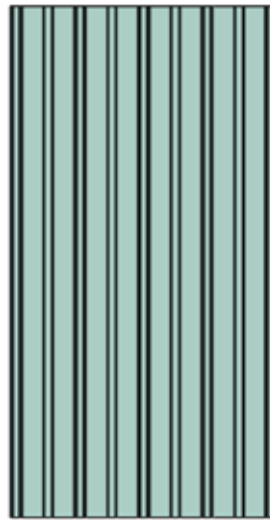

**8 x Sheeting**



**2 x Covers**



**4 x Sheeting**

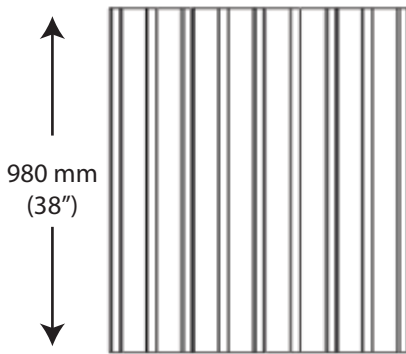

1800 mm  
(71")

2200 mm  
(86")

**30 x M12**

**4 x 70mm (2.7in)**

**20 x 80mm (3.1in)**

**6 x 120mm (4.7in)**



**2 x Ground Corner Plate**



**18 x Anchor Pegs**



**260 x 19mm**

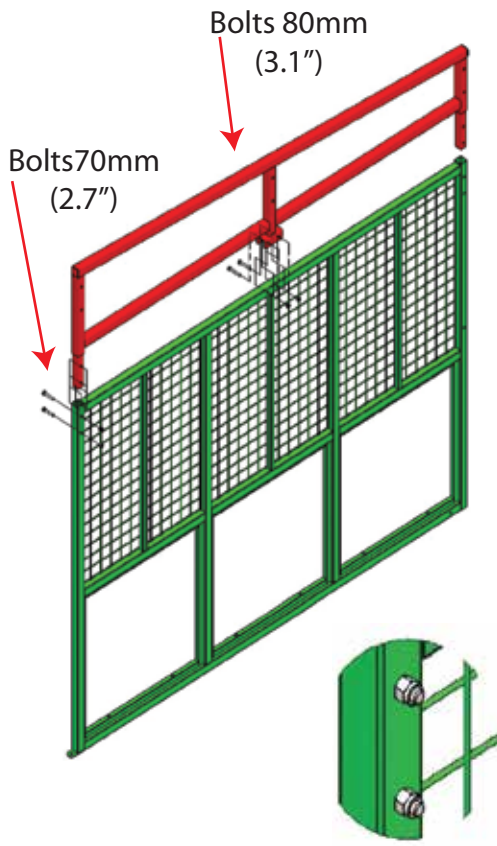

Left Side Panel

**Step 1:** Take the side panels and add the side roof support bars. Intalling bolts as shown

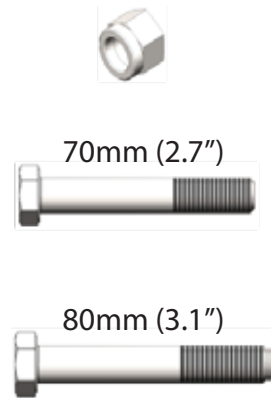
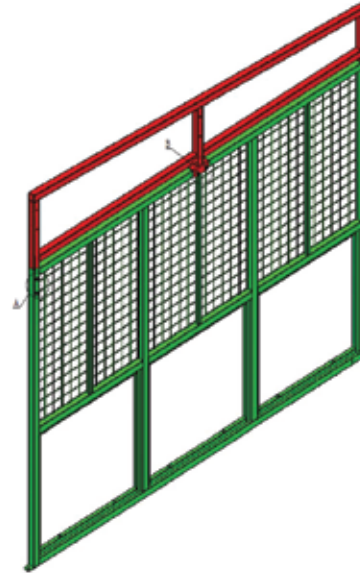

**Step 2:** Take the other side panel and do the same as above.

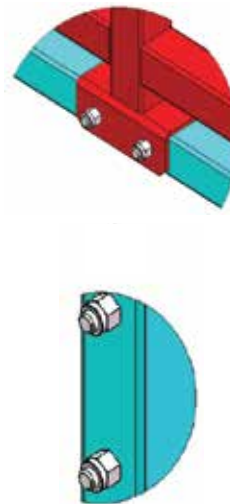
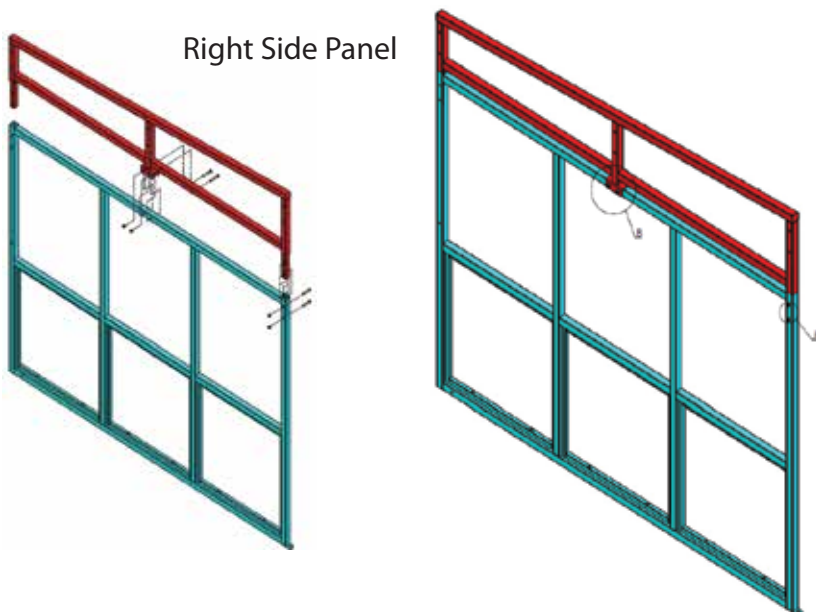

**Step 3:** Connect the back panel to the side panels. Side roof supports slope front to back.

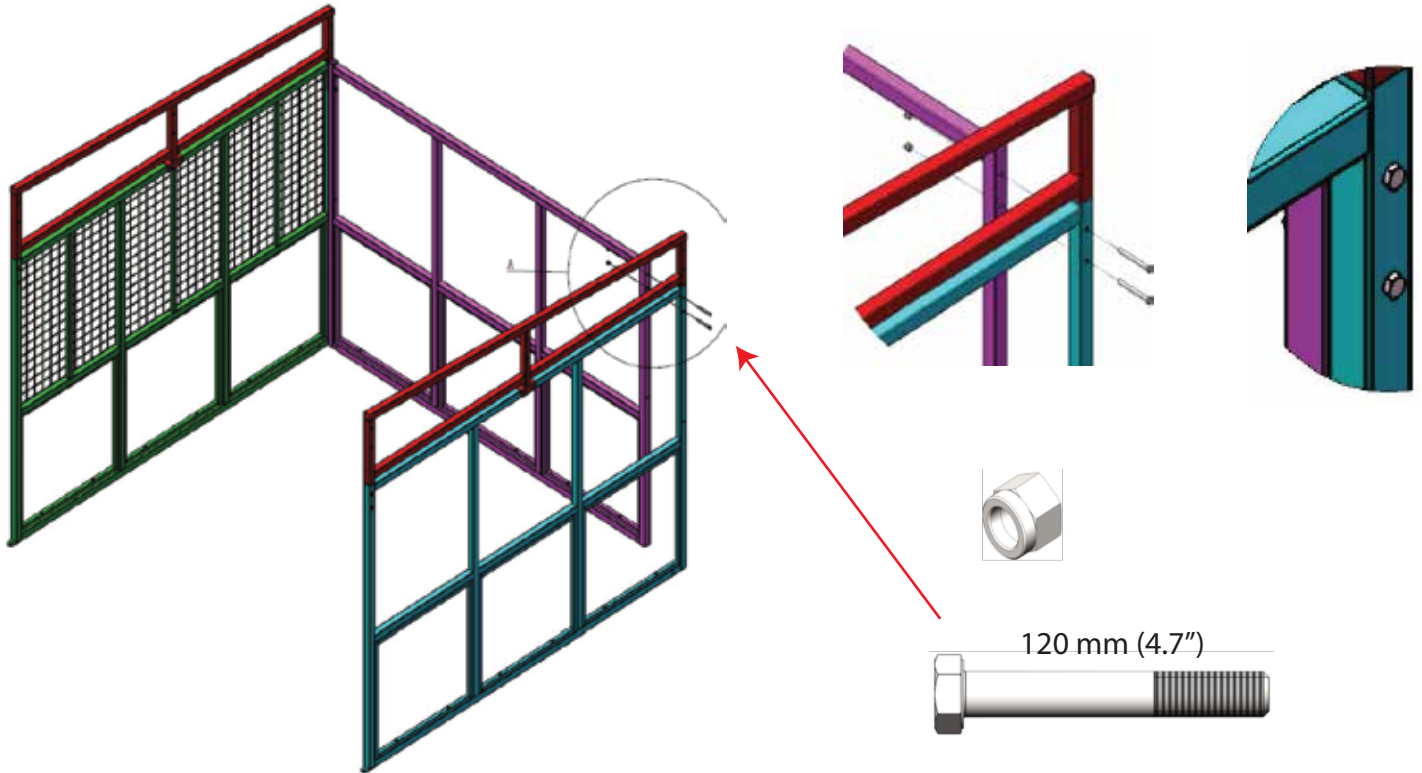

**Step 4:** Install the 3 Roof Trusses using the 80mm (3.1 inch) Bolts as shown in diagram.

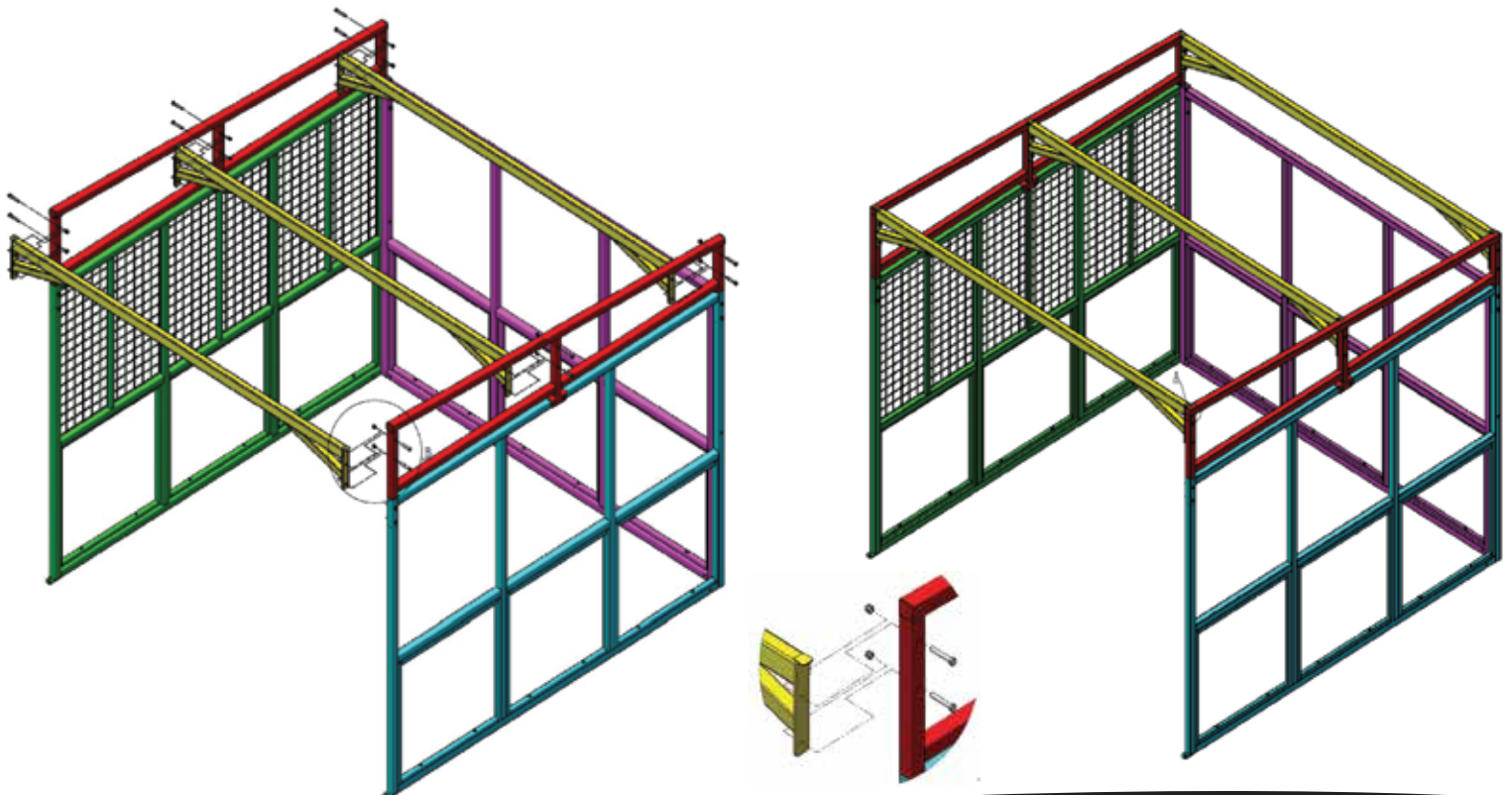

**Step 5:** Install the two bottom corner brackets using the 80mm (3.1") bolts.

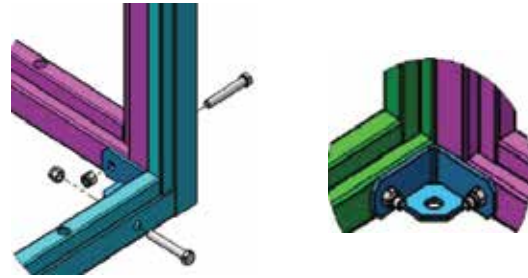
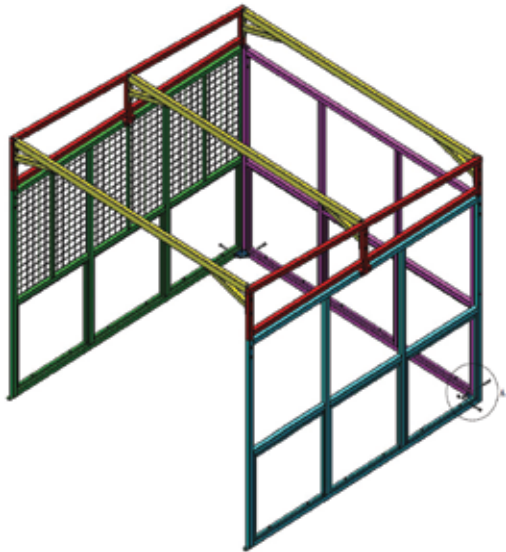

4 pcs sheet  
2200mm (86")

4 pcs sheet  
2200mm (86")

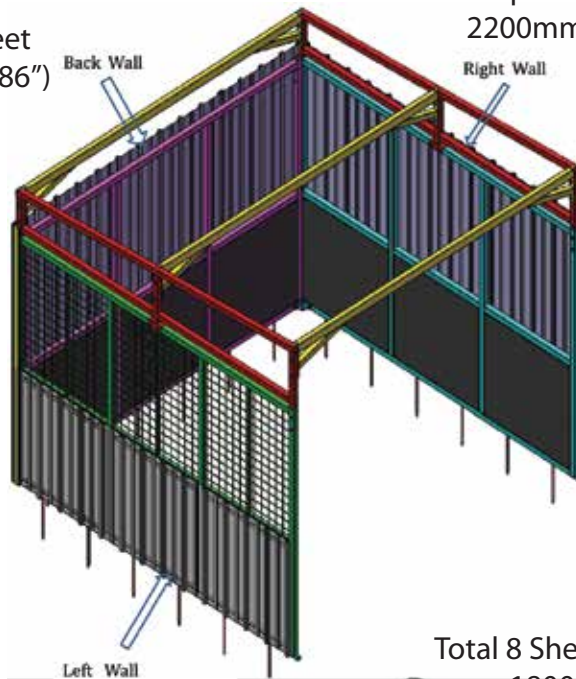

**Step 6:** Install the side sheeting. Using the 19mm self drilling screws. It is best to use them on the high point for the roof. For the side sheeting it does not really matter.

**Step 7:** Install the roof sheeting.

1 sheet  
1800mm (71")

Join. Overlap  
front sheet over  
back sheet for  
rain run off.

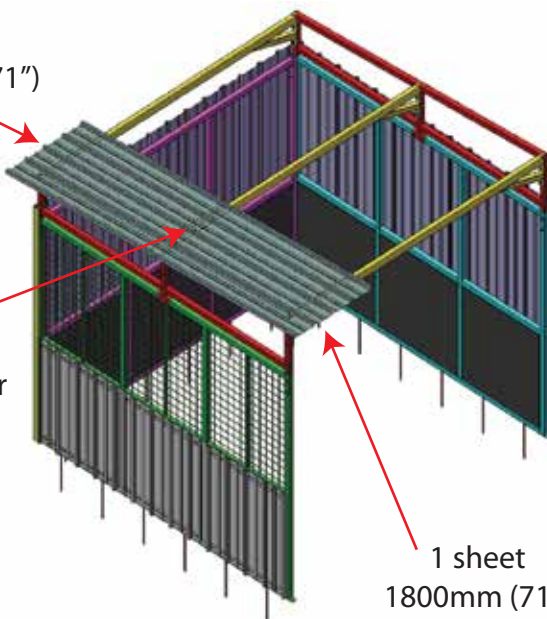

1 sheet  
1800mm (71")

4 pcs sheet  
980mm (38")

Total 8 Sheets on the roof  
1800mm (71")

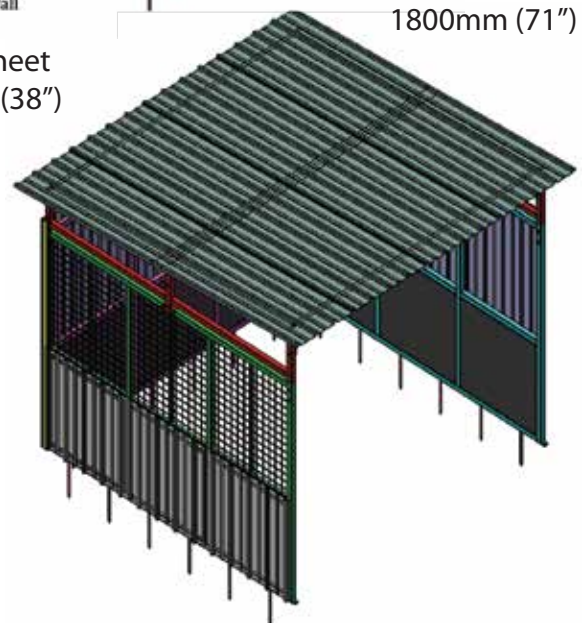

**Step 8:** Drive the pegs down where needed.

Foot Pegs Are Optional

